



# HTO 120

## 2" x 1 1/2" CENTRIFUGAL PUMP

### AIR COOLED – NO COOLING JACKET OR FLUSH REQUIRED

HTO 120 is a patented, unique centrifugal pump designed for high temperature applications, such as the plastics, chemical, food and processing industries. The pump can be used in horizontal or vertical positions and is available with or without an electric motor.

### PUMP SPECIFICATIONS

Suction and Discharge .....	2" x 1 1/2" NPT or 125# Flange
Housing .....	Ductile Iron
Drive Sleeve .....	Hardened 303SS
Standard Seal .....	Carbon/Silicon Carbide and Viton
Working Pressure .....	150 psi (max)
Temperature .....	650°F (343°C) (max)



## WARNING

Consult factory for applications approval and usage. Serious injury or death caused by burns from hot oil may occur.

### CLOSE-COUPLED NEMA 145TC & 184C

### 2 H.P. • 3 H.P. • 5 H.P.

- With Or Without Electric Motor
- Bearing Pedestal Available



## MP PUMPS, INC.

TECUMSEH PRODUCTS COMPANY

34800 BENNETT DRIVE • FRASER, MI 48026-1686  
(586) 293-8240 • FAX (586) 293-8469

800-563-8006

[www.mppumps.com](http://www.mppumps.com)

# HTO 120

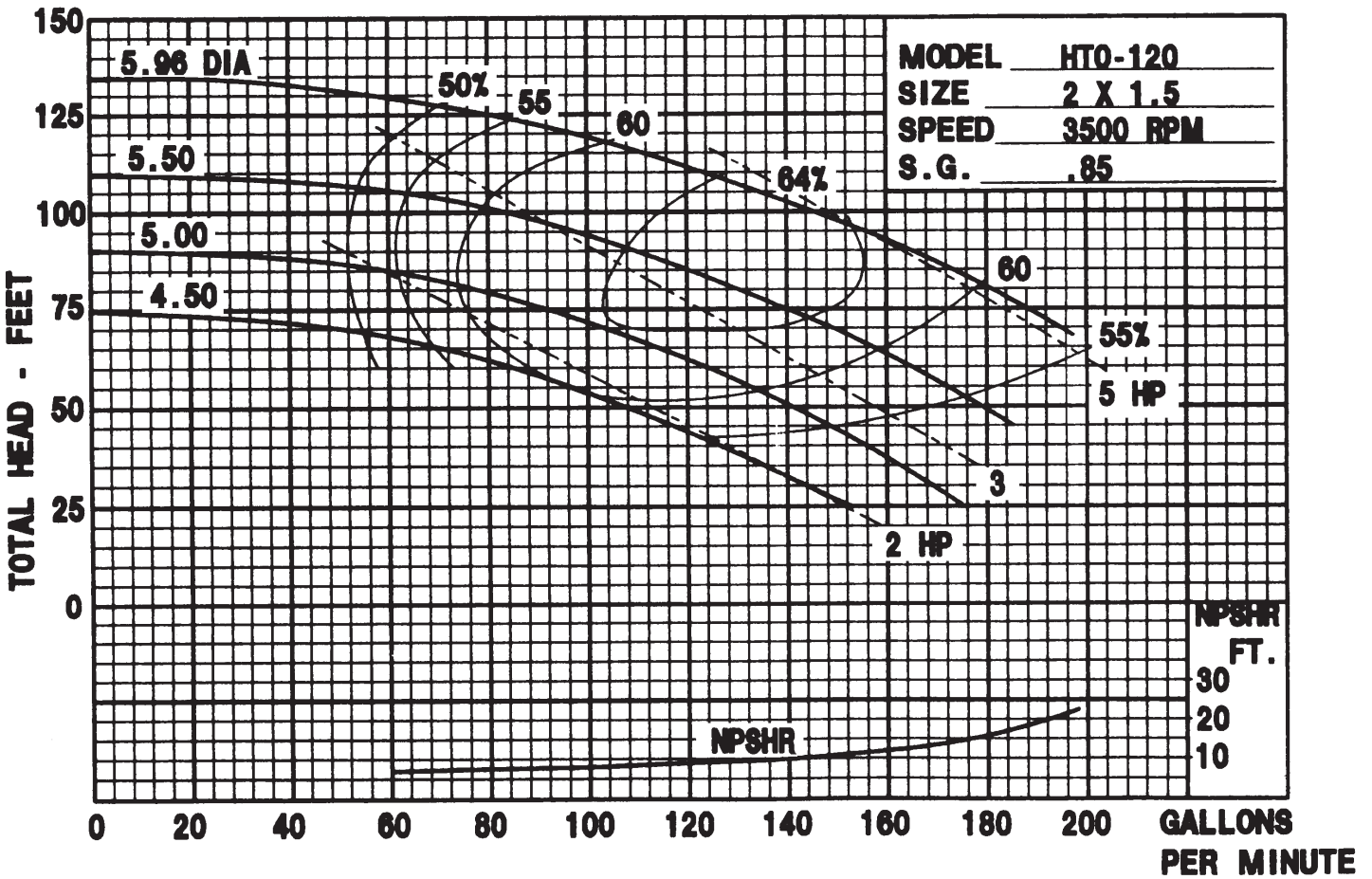
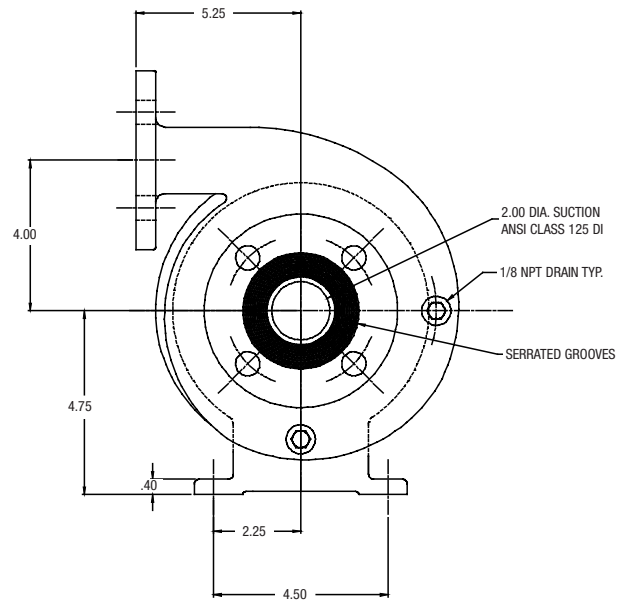
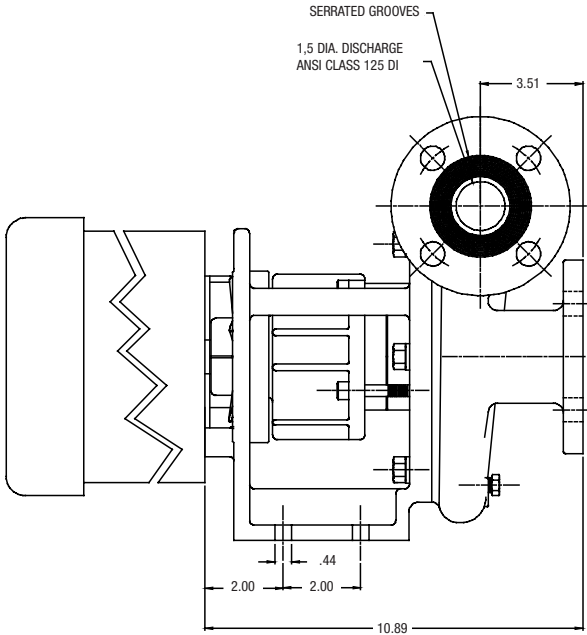

**MP PUMPS, INC.**

TECUMSEH PRODUCTS COMPANY

34800 BENNETT DRIVE • FRASER, MI 48026-1686  
(586) 293-8240 • FAX (586) 293-8469

800-563-8006

www.mppumps.com

FORM 9051 (2/02)  
Litho in USA